

Prairie Lawn Road and Spruce Street Improvements

Welcome!

Design Open House
December 15, 2022
7:15 PM



Project Location and Limits

- Prairie Lawn Road: From Linneman Street to Glenview Road (approximately 1,300 feet)
- Spruce Street: From Glenview Road to Fir Street (approximately 1,300 feet)
- All work to be completed within the public right-of-way
- Construction year: 2023



Scope of Work and Benefit to Residents

- Replacement of existing **water main** with new **8-inch diameter water main**, including new **1 ½ -inch water services** and new **b-boxes**
- Upgrade of existing **storm sewer system**
- **Sanitary service** replacements
- Construct **new asphalt pavement**
- Install **new concrete curb and gutter**
- **Driveway apron** replacement (in-kind)
- **Parkway restoration** with sod

Existing and Proposed Typical Plans – Prairie Lawn Road

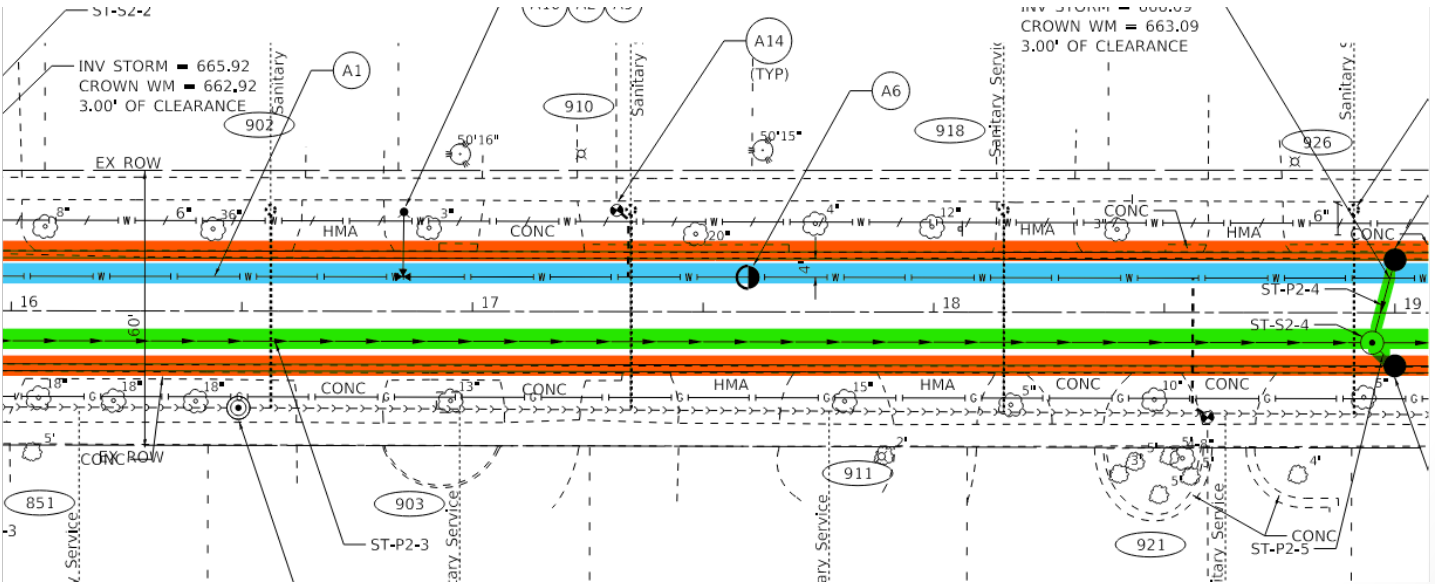
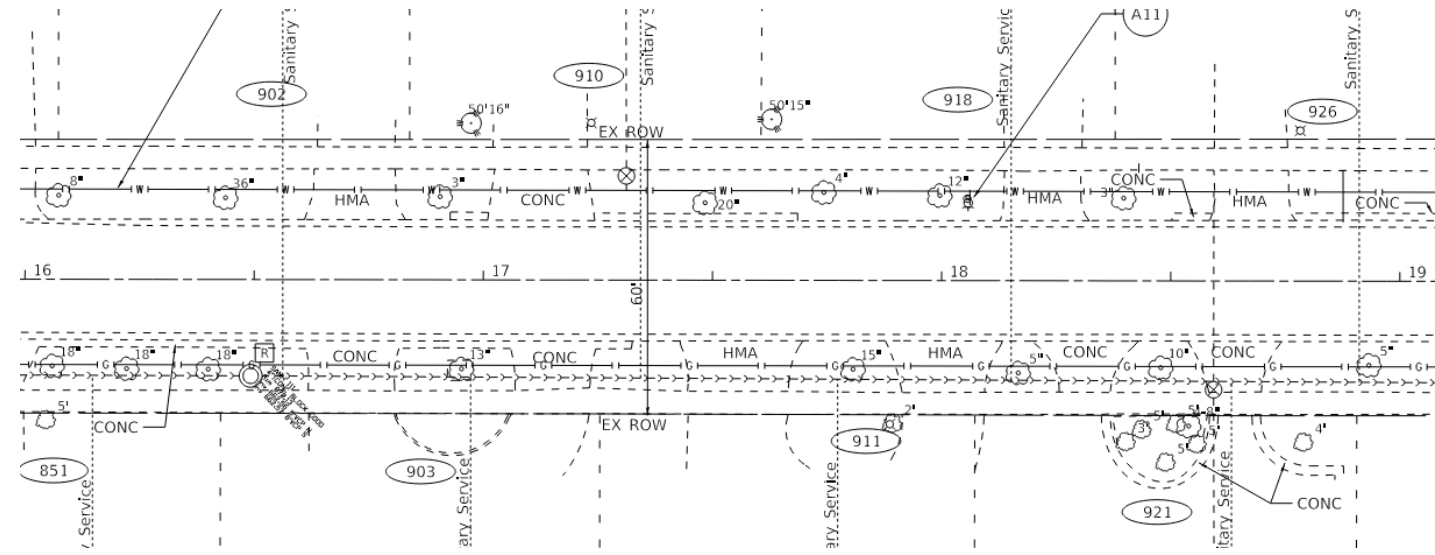

New Curb & Gutter

New Water Main

New Storm Sewer

Existing and Proposed Typical Plans – Spruce Street

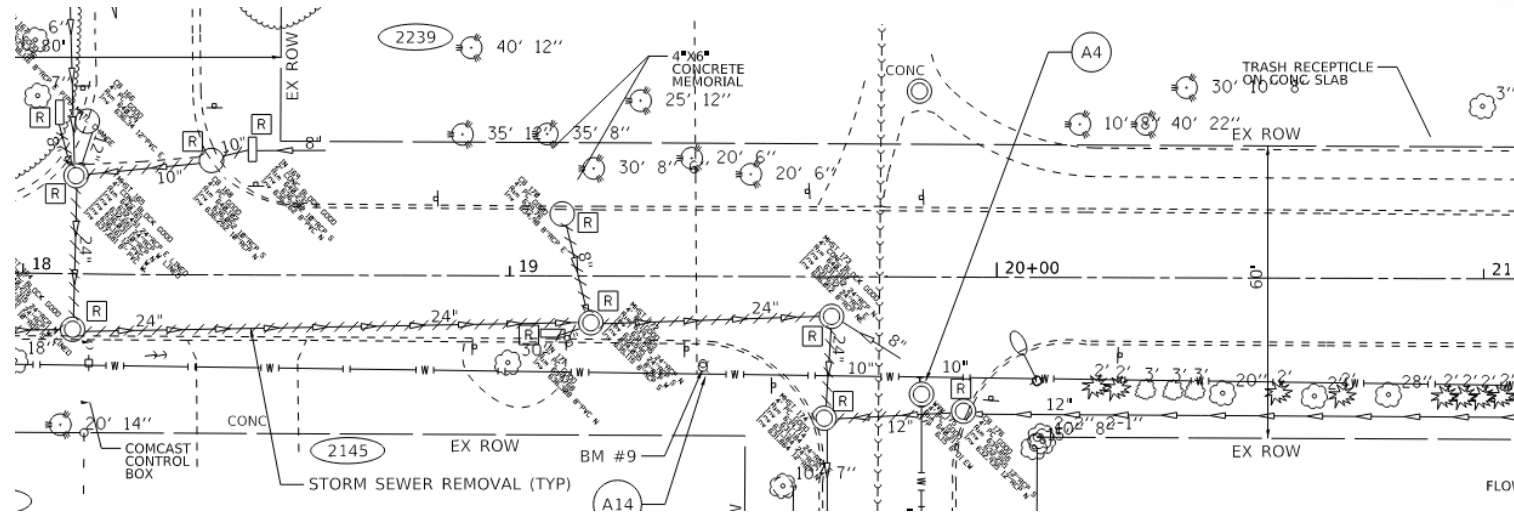

New Curb & Gutter

New Water Main

New Storm Sewer

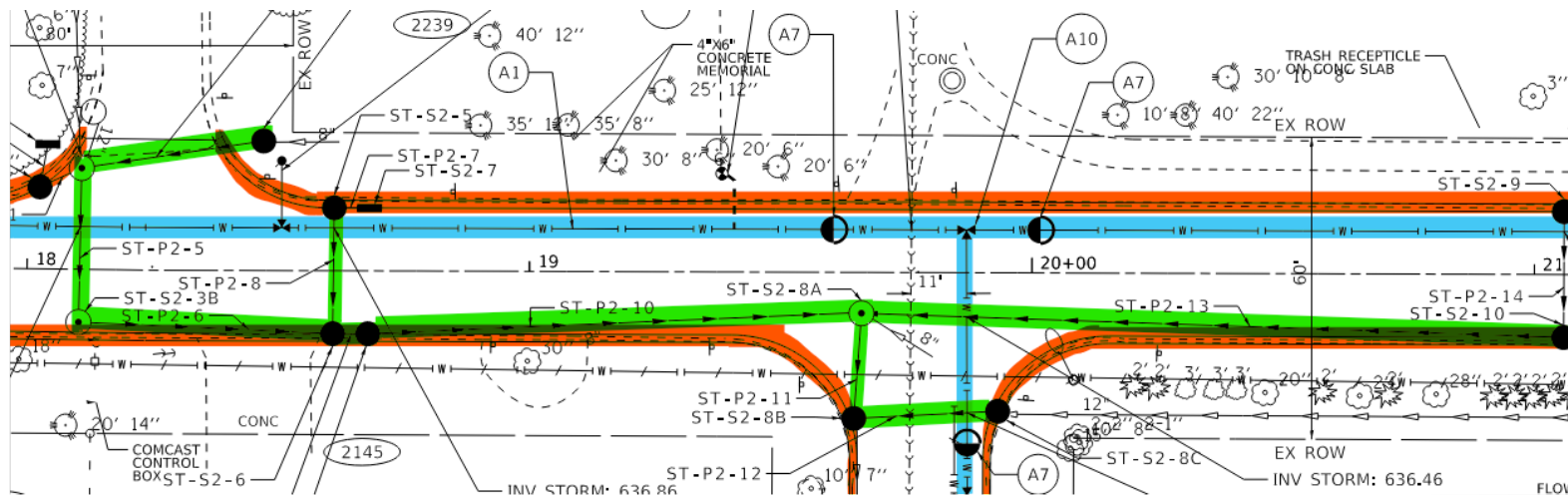

Tentative Schedule and Next Steps

Dates	Steps
December 2022	Finalize Design Plans and Bidding Process
December 16, 2022 (Today)	Design Open House Meeting
February 2023	Contract Award
February 2023	Pre-construction Resident Meeting
March 2023	Anticipated Start Date
June 2023	Anticipated Completion Date

Resident's FAQ's

If my driveway is damaged, will it be fixed or replaced?

- Sections of private driveways located in the public right-of-way will be replaced if damaged during construction with the exception of edging materials and brick paver driveways. Reimbursement is available for reinstallation of brick pavers with the driveway apron located in the public right-of-way.

Will my driveway be closed during construction?

- Private drives will be accessible the majority of the time during construction. If your driveway needs to be closed, notice will be provided to allow adequate time to make arrangements.

Will the parkway be restored after construction is completed?

- Parkway areas disturbed by construction will be restored with sod during the last stage of construction. Please note that residents are responsible for the removal of private items located within the public parkway such as landscaping features, fencing, boulders, sprinklers, planters, etc. These items will not be replaced if damaged.

Will garbage pick up or bus pickup & drop off be impacted?

- The garbage service in your neighborhood will not be impacted during construction.
- Before bus routes are impacted, the school, bus company, and residents will be notified in advance of any alternate bus pick up and drop off.

Project Updates

1. Navigate to <https://www.glenview.il.us/Pages/Default.aspx>

2. Select Traffic & Transportation > Construction Projects

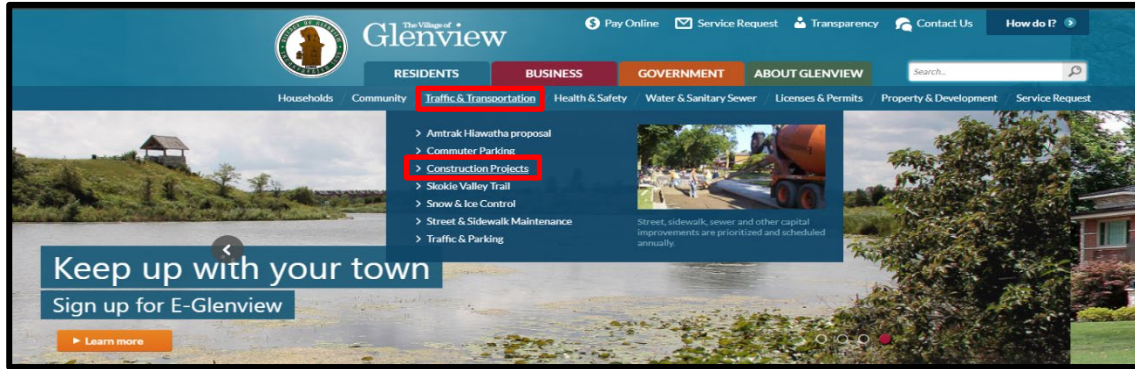

3. Scroll down to 2023 Public Improvements Project List and select Prairie Lawn Road or Spruce Street Improvements

4. Scroll down to Notification Signup and enter your information

- Project Website Information and updates will be available during pre-construction resident meeting
- Sign up to receive weekly updates
- Keep your eyes open for hand-delivered letters and door hangers throughout the project

Project Updates

Find all [project updates here](#).

To sign up for future notifications on this project, fill out the form below. We will email updates on this project when they are available.

First Name	<input type="text"/>
Last Name	<input type="text"/>
Email Address	<input type="text"/>
Confirm Email Address	<input type="text"/>
Street Number	<input type="text"/>
Street Name	<input type="text"/>
Phone number	<input type="text"/>
<input type="submit" value="Submit"/>	

Please click the submit button once. Submission time is based on connection speed. This form will update to confirm your information was submitted.

Contact Us

Construction Project Manager

Eric Pugh

Email: epugh@glenview.il.us

Phone: (847) 904- 4235

Engineering Manager

Adriana Webb

Email: awebb@glenview.il.us

Phone: (847) 904-4414

If you consider doing work on your private property, a permit is required for:

- New driveway
- Private drain and connection to public sewer

Get more information here:

<https://www.glenview.il.us/Pages/Building-Permits.aspx>