

# Tall Trees

Presentation to  
Village of Glenview  
Storm Water Task Force  
February 11, 2009

Susan Johns  
Peter Stettler



# Tall Trees

- Agenda
  - Introduction to the neighborhood
  - Tall Trees storm water drain network
  - Tall Trees relationship to major storm water detention areas
  - Tall Trees and the current floodplain map
  - 2007
  - 2008
  - Our concerns
  - Are there solutions??????



# Tall Trees Neighborhood

- 194 homes
- Built 1960s
- Before flood map and detention requirements developed

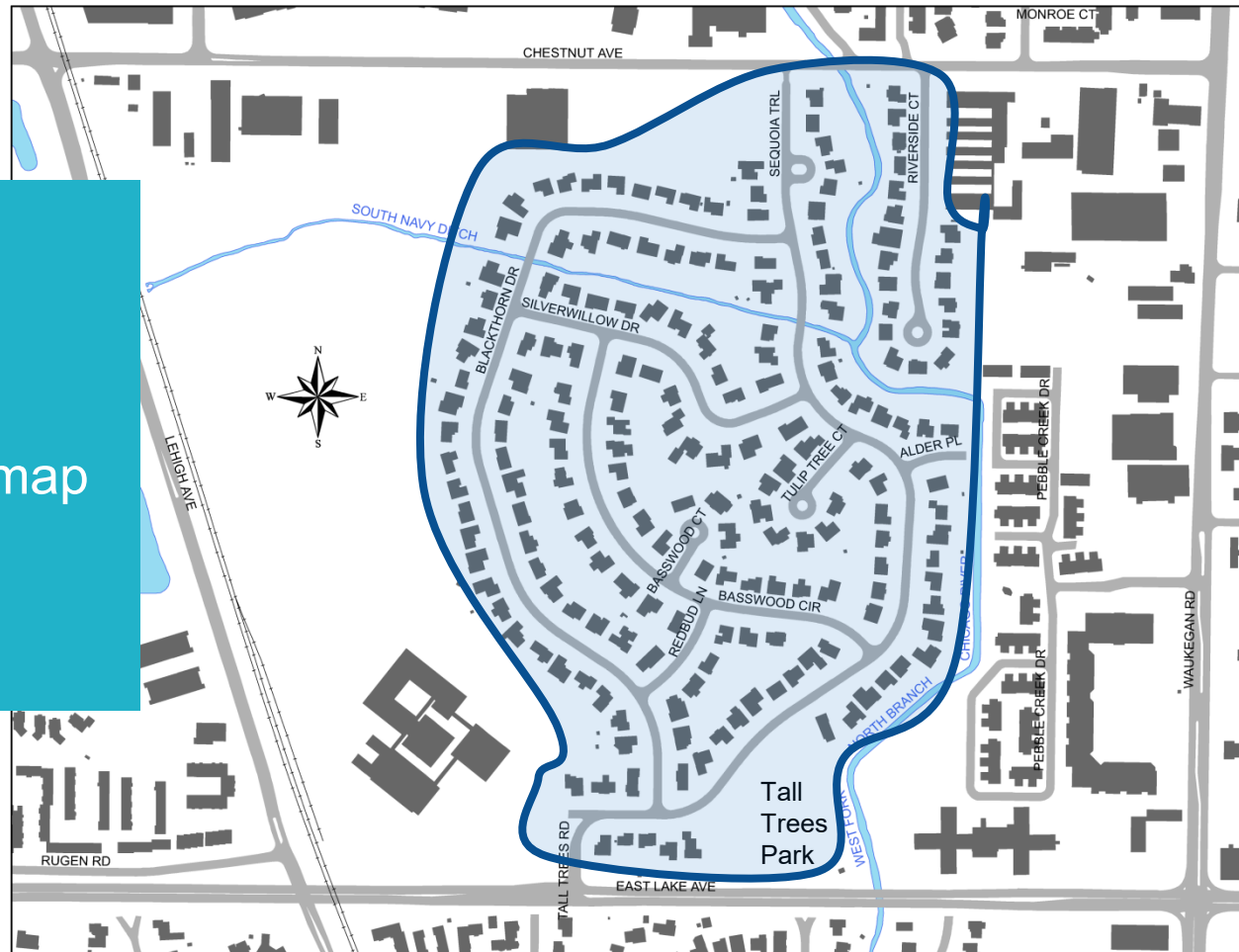

# Chicago River

- Flows from northern suburbs through Glenview
- 71% of the Village drains to the West Fork
- Traverses Tall Trees North to South

Normal State – Feb 7, 2009  
Looking South from Chestnut



September 12, 2008  
Looking South from Chestnut



# Chicago River

Normal State – Feb 7, 2009  
Chestnut Overpass



September 12, 2008  
Chestnut Overpass



# South Navy Ditch

- Built to provide drainage from former Glenview Naval Air Station airfield to the Chicago River
- Traverses Tall Trees West to East
- Joins Chicago River within Tall Trees
- MWRD responsible for maintaining
- Characteristics:
  - Steep banks
  - Flat bottom, little slope
  - Generally flows west to east
  - When Chicago River rises flows east to west

Looking east from Sequoia Trail  
Confluence with Chicago River



Feb 7, 2009

# South Navy Ditch



Looking west from  
Blackthorn Drive

Looking west from Sequoia Trail



Feb 9, 2009

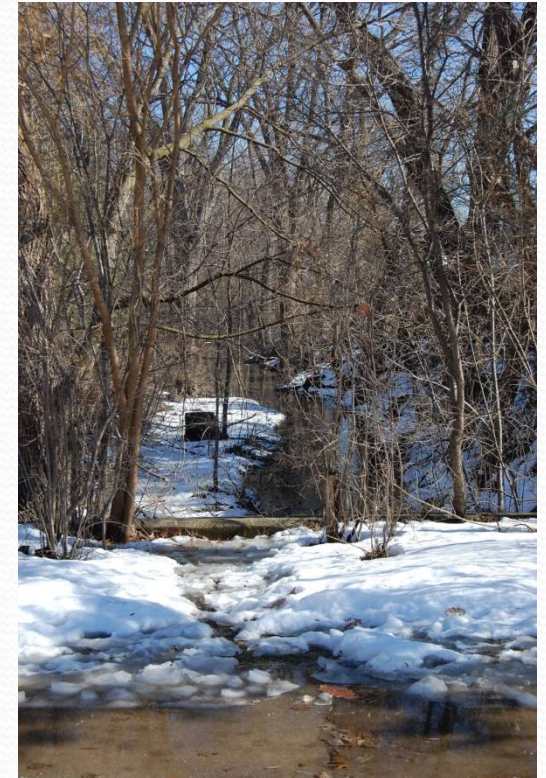

Looking east from  
Blackthorn Drive

# Tall Trees Storm Water Drains

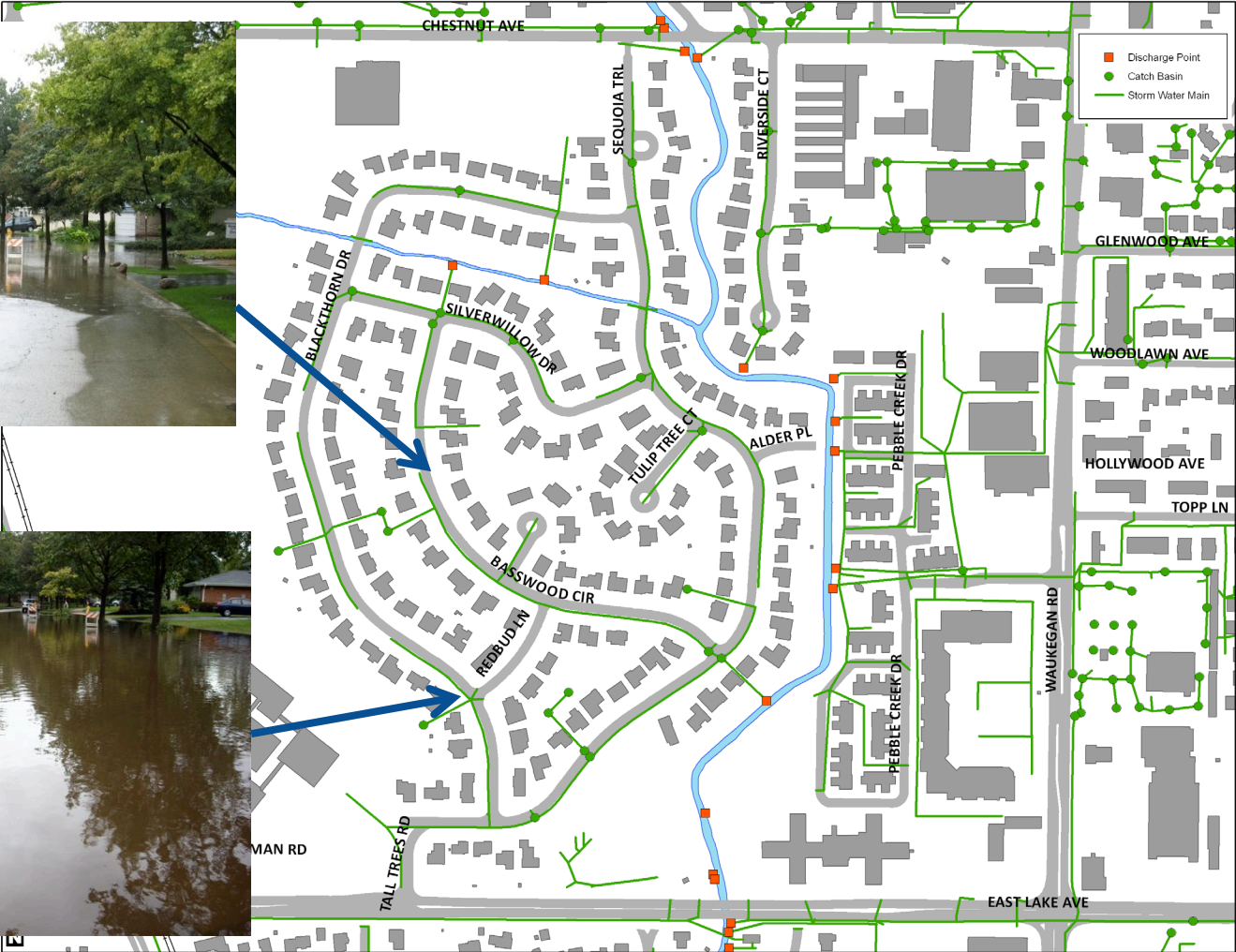

The data provided herein is "as is" without warranties of any kind. The Village of Glenview, its officials, employees, agents, attorneys or other representatives shall have no liability for any errors, omission or inaccuracies in the information.



# Major Storm Water Detention Sites

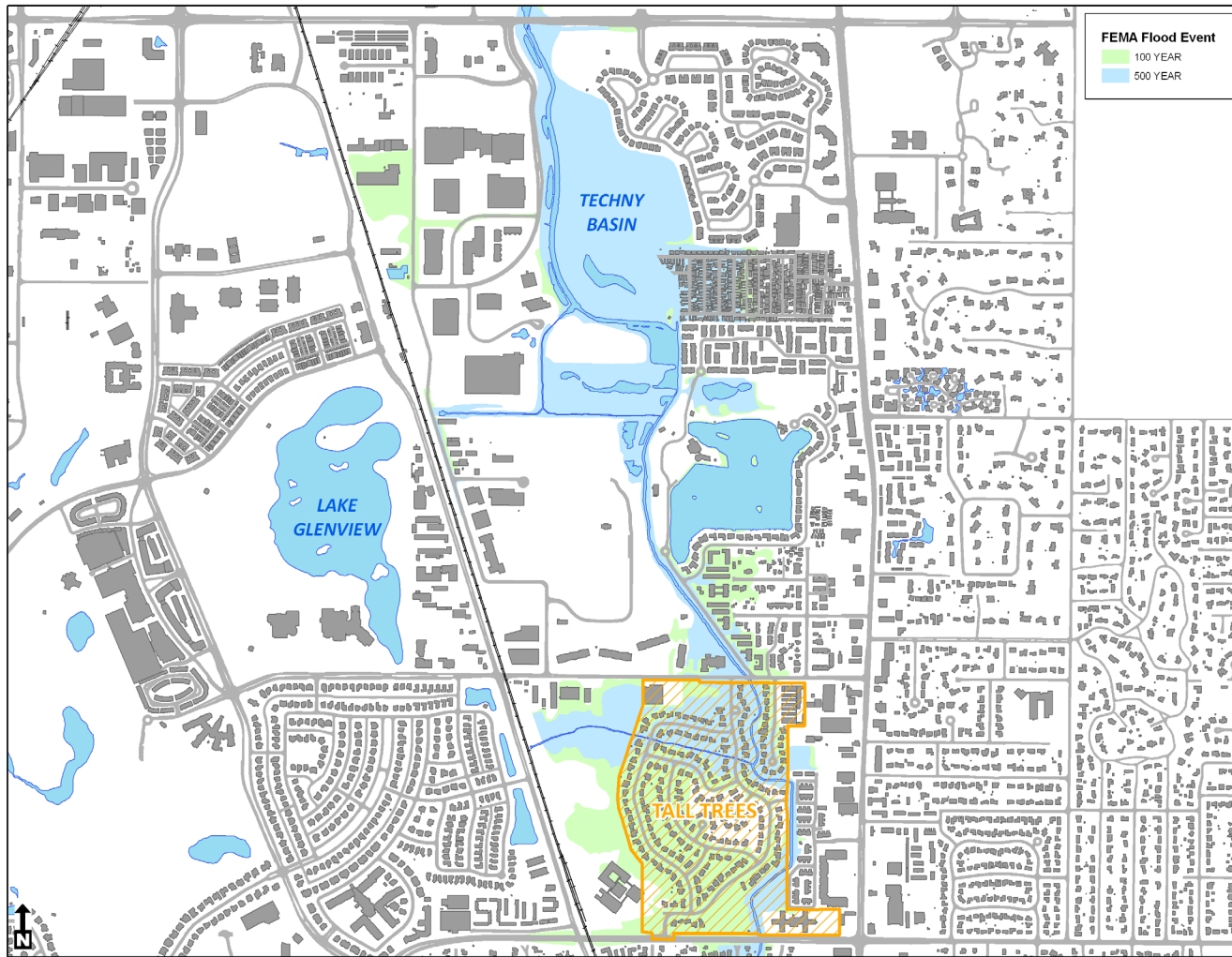

# Tall Trees Floodplain



# August 2007

- Severe wind damage
- Power outage
- Basement Flooding – sump pump failures



- Techny Basin reached capacity
- Sand bags and evacuation notice issued
- S. Navy Ditch at top of banks, Scott Foresman property flooded

# September 2008

- Tall Trees experiences extensive flooding
  - Street
  - Over foundation
  - Basement
- Flooding occurred in morning, before Techny Basin reached capacity
- Second high water mark when Techny overflowed
  - Highest water around 12 midnight



Sequoia Trail looking South from Chestnut



# Street Flooding – September 2008

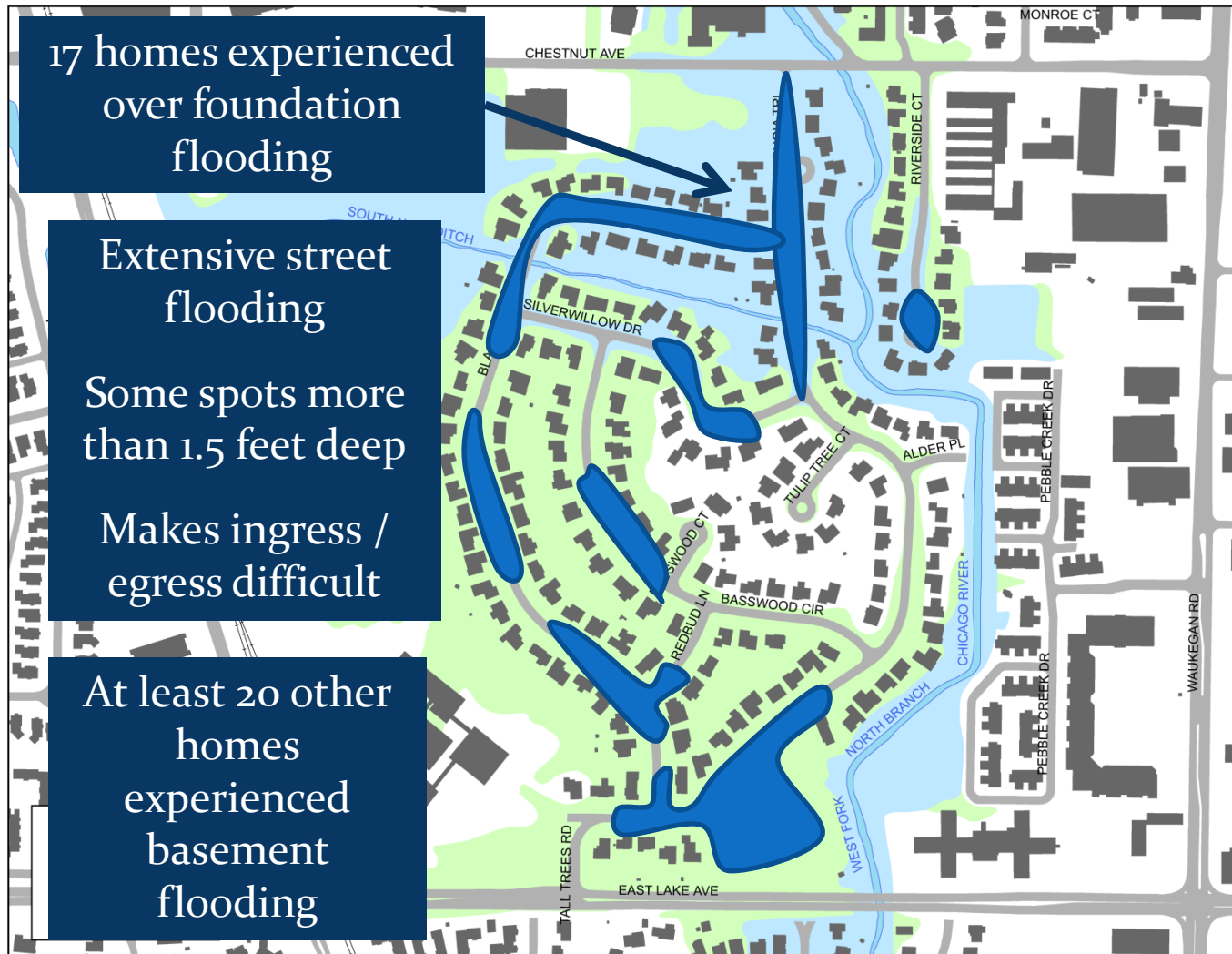

# Our Concerns

- We are low
  - How is water coming toward us?
  - Relationship between River / Ditch / Storm Drains
  - Effect of development on drainage patterns
- Safety
  - Ingress / egress
  - Senior citizens / disabled
- Homes
  - Damage to property
  - Hazards – electricity, gas, sewage



# The General Board Development

## Where we see risk



Not to scale /  
approximate  
locations

# Are There Solutions???????

- We need someplace for the water to go
- Enlarge Techny Basin
  - Help control upstream flows
  - Not a complete solution
    - 2008 Flood indicates more needs to be done south of the Techny Basin
- Can other parcels be used for flood mitigation
  - Tall Trees Park, other parks?
  - Lot 17?
  - Downstream locations – Forest Preserve?
- When the next event occurs
  - Improved coordination

